

HSA 94 R, 94 T

**STIHL**



2 - 21	Gebrauchsanleitung
21 - 38	Instruction Manual
38 - 59	Notice d'emploi
60 - 78	Istruzioni d'uso
78 - 98	Handleiding



- g) **Verwenden Sie die Heckenschere nicht bei schlechtem Wetter, besonders nicht bei Gewittergefahr.** Dies verringert die Gefahr, von einem Blitz getroffen zu werden.



Dr. Nikolas Stihl

**IMPORTANT! READ BEFORE USING AND KEEP IN A SAFE PLACE FOR REFERENCE.**

## Contents

1	Introduction.....	21
2	Guide to Using this Manual.....	21
3	Overview.....	22
4	Safety Precautions.....	23
5	Preparing Hedge Trimmer for Operation..	26
6	Adjusting Hedge Trimmer for User.....	27
7	Inserting and Removing Connecting Cable Plug.....	29
8	Switching the Hedge Trimmer On/Off.....	29
9	Checking the Hedge Trimmer.....	30
10	Operating the Hedge Trimmer.....	30
11	After Finishing Work.....	31
12	Transporting.....	31
13	Storing.....	31
14	Cleaning.....	32
15	Maintenance.....	32
16	Repairing.....	32
17	Troubleshooting.....	33
18	Specifications.....	34
19	Spare Parts and Accessories.....	35
20	Disposal.....	35
21	EC Declaration of Conformity.....	35
22	UKCA Declaration of Conformity.....	35
23	General Power Tool Safety Warnings.....	36

## 1 Introduction

Dear Customer,

Thank you for choosing STIHL. We develop and manufacture our quality products to meet our customers' requirements. The products are designed for reliability even under extreme conditions.

STIHL also stands for premium service quality. Our dealers guarantee competent advice and instruction as well as comprehensive service support.

STIHL expressly commit themselves to a sustainable and responsible handling of natural resources. This user manual is intended to help you use your STIHL product safely and in an environmentally friendly manner over a long service life.

We thank you for your confidence in us and hope you will enjoy working with your STIHL product.

## 2 Guide to Using this Manual

### 2.1 Applicable Documents

The local safety regulations apply.

- In addition to this User Manual, you should also read, understand and retain the following documents:
  - User Manual for STIHL AR battery
  - User Manual for "AP belt bag with connecting cable"
  - Safety notices and precautions for STIHL AP battery
  - User Manual for STIHL AL 101, 301, 301-4, 500 chargers
  - Safety information for STIHL batteries and products with built-in battery:  
[www.stihl.com/safety-data-sheets](http://www.stihl.com/safety-data-sheets)

### 2.2 Warning Notices in Text

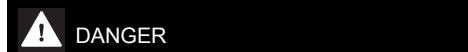

- This notice refers to risks which result in serious or fatal injury.
  - Serious or fatal injuries can be avoided by taking the precautions mentioned.



- This notice refers to risks which **can** result in serious or fatal injury.
  - Serious or fatal injuries can be avoided by taking the precautions mentioned.



- This notice refers to risks which can result in damage to property.
  - Damage to property can be avoided by taking the precautions mentioned.

### 2.3 Symbols in Text



This symbol refers to a chapter in this instruction manual.

## 3 Overview

### 3.1 Hedge trimmer

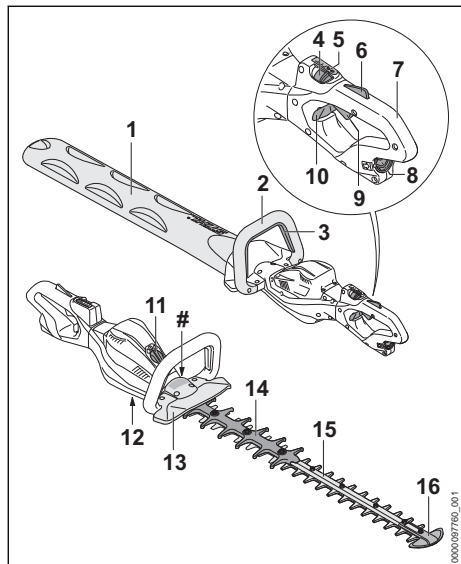

#### 1 Blade scabbard

The blade scabbard protects against contact with the cutting blades.

#### 2 Loop handle

The loop handle is used to hold, control and carry the hedge trimmer.

#### 3 Control bar

The control bar switches the hedge trimmer on and off together with the trigger.

#### 4 Retaining latch

The retaining latch unlocks the trigger switch together with the trigger lockout. It is also used to select the power level.

#### 5 LEDs

The LEDs indicate the selected power level.

#### 6 Trigger lockout

The trigger lockout unlocks the trigger together with the retaining latch.

#### 7 Control handle

The control handle is used to control, hold and guide the hedge trimmer.

#### 8 Socket

The socket receives the connecting cable plug.

#### 9 Trigger

The trigger switches the hedge trimmer on and off together with the control bar.

#### 10 Locking slide

Unlocks rotating control handle.

#### 11 Cover<sup>2</sup>

The cover is the placeholder for a Smart Connector 2 A.

#### 12 Screw plug

The screw plug closes the filler opening for STIHL multi-purpose grease.

#### 13 Hand guard

The hand guard protects the hand on the loop handle from contact with the cutting blades.

#### 14 Cut protection

The cut protection helps protect user's thigh from contact with rear end of the cutting blades.

#### 15 Cutting blades

The cutting blades cut the hedge.

#### 16 Tip guard

The tip guard protects the nose of the cutting blades from contact with foreign objects.

#### # Rating plate with machine number

### 3.2 Carrying Systems

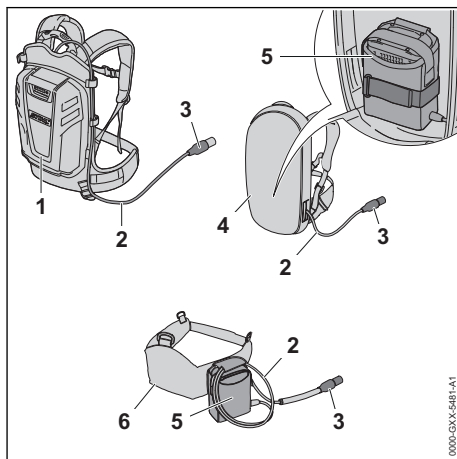

<sup>2</sup>The cover is part of the motor housing. Remove the cover only to install a Smart Connector 2 A and store it safely for later re-installation. Always use the hedge trimmer with the cover or Smart Connector 2 A installed.

**1 STIHL AR Battery**

Supplies power to the hedge trimmer.

**2 Connecting Cable**

Connects hedge trimmer to the battery or "AP belt bag with connecting cable".

**3 Connecting Cable Plug**

Connects hedge trimmer to "AP belt bag with connecting cable" or a STIHL AR battery.

**4 Carrying System with Built-In "AP Belt Bag with Connecting Cable"**

Supplies power to the hedge trimmer.

**5 "AP Belt Bag with Connecting Cable"**

Supplies power to the hedge trimmer.

**6 Battery Belt with "AP Belt Bag with Connecting Cable"**

Supplies power to the hedge trimmer.

**3.3 Symbols**

Meanings of symbols that may be on the hedge trimmer:



Retaining latch unlocks the trigger in this position.



Retaining latch locks the trigger in this position.



This symbol marks the filler opening for STIHL multipurpose grease.



Guaranteed sound power level according to directive 2000/14/EC in dB(A) in order to make sound emissions of products comparable.



Do not dispose of the product with your household waste.

**4 Safety Precautions****4.1 Warning Signs**

Meanings of warning signs on the hedge trimmer:



Observe safety notices and take the necessary precautions.



Read, understand and save the instruction manual.



Wear safety glasses.



Wear safety glasses and hearing protection.



Do not touch moving cutting blades.



Disconnect connecting cable plug from socket during work breaks, transport, storage, maintenance and repairs.

**4.2 Intended Use**

The STIHL HSA 94 R hedge trimmer is designed for cutting hedges, shrubs, bushes and scrub with thicker branches.

The hedge trimmer may be used in the rain.

The STIHL HSA 94 T hedge trimmer is designed for shaping and trimming hedges, shrubs, bushes and scrub with thinner branches.

Power to this hedge trimmer is supplied by a STIHL AP battery in combination with the "AP belt bag with connecting cable" or an STIHL AR battery.

**▲ WARNING**

- Batteries not explicitly approved for the hedge trimmer by STIHL may cause a fire or explosion. This can result in serious or fatal injuries and damage to property.
  - ▶ Use the hedge trimmer with a STIHL AP battery in combination with the "AP belt bag with connecting cable" or an STIHL AR battery.
- Using the hedge trimmer or the battery for purposes for which they were not designed may result in serious or fatal injuries and damage to property.
  - ▶ Use the hedge trimmer as described in this instruction manual.
  - ▶ Use the battery as described in the instruction manual for the "AP belt bag with connecting cable" or the STIHL AR battery.

**4.3 The Operator****▲ WARNING**

- Users without adequate training or instruction cannot recognize or assess the risks involved in using the hedge trimmer. The user or other persons may sustain serious or fatal injuries.



- ▶ Read, understand and save the instruction manual.

- ▶ If the hedge trimmer is passed on to another person: Always give them the instruction manual.
- ▶ Make sure the user meets the following requirements:
  - The user must be rested.
  - The user must be in good physical condition and mental health to operate and work with the hedge trimmer. If the user's physical, sensory or mental ability is restricted, he or she may work only under the supervision of or as instructed by a responsible person.
  - The user is able to recognize and assess the risks involved in using the hedge trimmer.
  - The user must be of legal age or is being trained in a trade under supervision in accordance with national rules and regulations.
  - The user has received instruction from a STIHL servicing dealer or other experienced user before working with the hedge trimmer for the first time.
  - The user must not be under the influence of alcohol, medication or drugs.
- ▶ If you have any queries: Contact a STIHL servicing dealer for assistance.

#### 4.4 Clothing and equipment

### ⚠ WARNING

- Long hair may be pulled into the hedge trimmer while working. This may result in serious injury to the user.
  - ▶ Tie up and confine long hair above your shoulders.
- Objects can be thrown at high speed during operation. This may result in injury to the user.



- ▶ Wear close-fitting safety glasses. Suitable safety glasses are tested in accordance with EN 166 or national regulations and available commercially with the corresponding marking.



- ▶ Wear a long-sleeved, close-fitting top and long trousers.
- Noise is generated during operation. Noise can damage your hearing.



- ▶ If this symbol appears on the hedge trimmer: Wear hearing protection.

- Dust can be whipped up during operation. Whipped up dust can damage the respiratory passages and cause allergic reactions.
  - ▶ If dust is generated: Wear a dust respirator mask.
- Unsuitable clothing can snag on wood or scrub and may become caught in the hedge trimmer. Users not wearing suitable clothing are at risk of serious injury.
  - ▶ Wear close-fitting clothing.
  - ▶ Remove scarves and jewelry.
- The user may come into contact with the moving cutting blades while working. This may result in serious injury to the user.
  - ▶ Wear robust footwear.
  - ▶ Wear long trousers made from resistant material.
- The user may come into contact with the cutting blades during cleaning or servicing. This may result in injury to the user.
  - ▶ Wear work gloves made from resistant material.
- Wearing unsuitable footwear may cause the user to slip. This may result in injury to the user.
  - ▶ Wear sturdy, closed-toed footwear with high-grip soles.

#### 4.5 Work Area and Surroundings

### ⚠ WARNING

- Innocent bystanders, children and animals cannot recognize or assess the dangers of the hedge trimmer or flying debris. Bystanders, children and animals may be seriously injured and damage to property may occur.
  - ▶ Keep bystanders, children and animals away from the work area.
  - ▶ Do not leave the hedge trimmer unattended.
  - ▶ Make sure that children cannot play with the hedge trimmer.
- Electrical components of the hedge trimmer can produce sparks. Sparks may cause a fire or an explosion in an easily combustible or explosive environment. This can result in serious or fatal injuries and damage to property.
  - ▶ Do not work in an easily combustible or explosive environment.

## 4.6 Safe Condition

### 4.6.1 Hedge trimmer

The hedge trimmer is in a safe condition if the following conditions are fulfilled:

- The hedge trimmer is undamaged.
- The hedge trimmer is clean.
- The controls function properly and have not been modified.
- The cutting blades are correctly fitted.
- Only an original STIHL accessory for this hedge trimmer has been fitted.
- The accessories are correctly attached.

## ⚠ WARNING

- If not in safe condition, components may no longer operate correctly and safety devices may be disabled. This may result in serious or fatal injury to people.
  - ▶ Never use a damaged hedge trimmer.
  - ▶ If the hedge trimmer is dirty: Clean the hedge trimmer.
  - ▶ Do not modify the hedge trimmer.
  - ▶ If the controls do not work: Do not operate the hedge trimmer.
  - ▶ Only fit original STIHL accessories for this hedge trimmer.
  - ▶ Attach accessories as described in this User Manual or in the User Manual for the accessories.
  - ▶ Do not insert objects into the openings in the hedge trimmer.
  - ▶ Replace worn or damaged labels.
  - ▶ If you have any doubts, be sure to consult a STIHL dealer.

### 4.6.2 Cutting Blades

The cutting blades are in a safe condition if the following points are observed:

- Cutting blades are undamaged.
- Cutting blades are not deformed.
- Cutting blades move freely.
- Cutting blades are properly sharpened.
- Cutting blades have no burrs.

## ⚠ WARNING

- If they are in an unsafe condition, parts of the cutting blades may come off and be thrown at high speed. This can result in serious injuries.
  - ▶ Work only with undamaged cutting blades.
  - ▶ Make sure the cutting blades are properly sharpened and deburred.
  - ▶ If you have any queries: Contact your STIHL servicing dealer.

## 4.7 Operation

## ⚠ WARNING

- The user cannot concentrate on the work in certain situations. The user may stumble, fall and be seriously injured.
  - ▶ Work calmly and carefully.
  - ▶ If light and visibility are poor: Do not use your hedge trimmer.
  - ▶ Operate the hedge trimmer alone.
  - ▶ Watch out for obstacles.
  - ▶ Stand on the ground while working and keep a good balance. If it is necessary to work at heights: Use a lift bucket or a safe platform.
  - ▶ If you begin to feel tired: Take a break.
- Working above shoulder height can cause you to tire quickly. This can result in serious injuries.
  - ▶ Work above shoulder height for short periods only.
  - ▶ Take regular breaks.
- If the moving cutting blades make contact with a hard object they can be brought to a sudden stop. The reactive forces that occur can cause the user to lose control of the hedge trimmer and be seriously injured.
  - ▶ Hold the hedge trimmer firmly with both hands.
  - ▶ Before starting work, check hedge for hard objects and remove any such objects.
- The moving cutting blades can cut the user. This can result in serious injuries.
 

  - ▶ Do not touch moving cutting blades.
  - ▶ If the cutting blades are blocked by an object: Switch off the hedge trimmer and pull the connecting cable plug out of the socket. Then remove the object causing the blockage.
- If the behavior of the hedge trimmer changes during operation or feels unusual, it may no longer be in a safe condition. This can result in serious injuries and damage to property.
  - ▶ Stop work, pull the connecting cable plug out of the socket and contact your STIHL servicing dealer.
- Hedge trimmer vibrations may occur during operation.
  - ▶ Wear gloves.
  - ▶ Take regular breaks.
  - ▶ If signs of circulation problems occur: Seek medical advice.
- Note that the cutting blades continue to run for about 1 second after you release the trigger. The moving cutting blades can cut the user. This can result in serious injuries.



- ▶ Hold the hedge trimmer firmly by the control handle and loop handle and wait until the cutting blades come to a complete stand-still.

## ⚠ DANGER

- Working near live electric cables can result in accidental contact with the cutting blades and damage the cables. This can result in serious or fatal injuries.
  - ▶ Do not work near live electric cables.





## 4.8 Transporting

### ⚠ WARNING

- The hedge trimmer may turn over or shift during transport. This may result in personal injuries and damage to property.
  - ▶ Push the retaining latch into position .
  - 
    - ▶ Pull the connecting cable plug out of the socket.
  - ▶ Fit the blade scabbard so that it completely covers the cutting blades.
  - ▶ Secure the hedge trimmer with lashing straps or a net to prevent it turning over and moving.



## 4.9 Storing

### ⚠ WARNING

- Children are not aware of and cannot assess the dangers of a hedge trimmer and can be seriously injured.
  - ▶ Push the retaining latch into position .
  - 
    - ▶ Pull the connecting cable plug out of the socket.
  - ▶ Fit the blade scabbard so that it completely covers the cutting blades.
  - ▶ Store the hedge trimmer out of the reach of children.
- Dampness can corrode the electrical contacts on the hedge trimmer and metal components. This can damage the hedge trimmer.
  - ▶ Push the retaining latch into position .
  - 
    - ▶ Pull the connecting cable plug out of the socket.
  - ▶ Store the hedge trimmer in a clean and dry condition.

## 4.10 Cleaning, Maintenance and Repair



### ⚠ WARNING

- The hedge trimmer may start unintentionally if the connecting cable plug is not removed during cleaning, maintenance or repair operations. This may result in serious injury to people and damage to property.
  - ▶ Move the retaining latch to the  position.
  - 
    - ▶ Pull the connecting cable plug out of the socket.
- Aggressive cleaning agents, cleaning with a jet of water or pointed objects can damage the hedge trimmer and the cutting blades. If the hedge trimmer or cutting blades are not cleaned correctly, components may no longer function properly or safety devices may be rendered inoperative. They may cause serious injury to persons.
  - ▶ Clean the hedge trimmer and cutting blades as described in this user manual.
- If the hedge trimmer or cutting blades are not serviced or repaired correctly, components may no longer function properly or safety devices may be rendered inoperative. This may result in serious or fatal injury to people.
  - ▶ Service or repair the hedge trimmer and cutting blades as described in this user manual.
- The user can be cut by the sharp cutting edges while cleaning or servicing the cutting blades. This may result in injury to the user.
  - ▶ Wear work gloves made from resistant material.



## 5 Preparing Hedge Trimmer for Operation

### 5.1 Preparing Hedge Trimmer for Operation

The following steps must be performed before commencing work:

- ▶ Ensure that the following components are in a safe condition:
  - Hedge trimmer,  4.6.1.
  - Cutting blades,  4.6.2.
  - Battery as described in the STIHL AR battery's instruction manual or in the instruction manual for the "AP belt bag with connecting cable".



- ▶ Check the battery as described in the STIHL AR battery's instruction manual or in the instruction manual for the "AP belt bag with connecting cable".
- ▶ Fully charge battery as described in the User Manual for the STIHL AL 101, 301, 301-4, 500 chargers.
- ▶ Clean the hedge trimmer,  14.1.
- ▶ Check the controls,  9.1.
- ▶ Put on and adjust the STIHL AR battery, carrying system or "AP belt bag with connecting cable",  6.
- ▶ If you cannot carry out this work: Do not use your hedge trimmer and contact your STIHL authorized dealer.

## 6 Adjusting Hedge Trimmer for User

### 6.1 Using with STIHL AR Battery

#### 6.1.1 Fitting and Adjusting the Connecting Cable

The connecting cable can be fitted and adjusted to suit the user's size and the application.

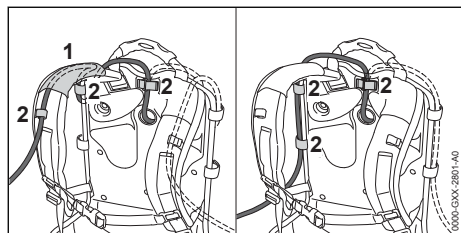

The connecting cable can be secured in position by the guide (1) on the harness and the fasteners (2), or on the side of the backplate with the fasteners (2).

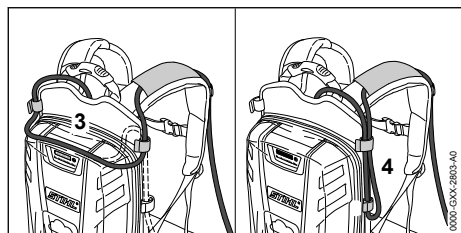

The length of the connecting cable can be adjusted by making a loop on the backplate (3) or at one side (4).

- ▶ Arrange the connecting cable so that it is as short as possible without hindering your work.

### 6.1.2 Putting On and Adjusting the Carrying System

- ▶ Place battery on your back.

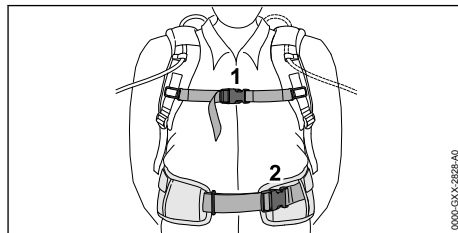

- ▶ Close fastening (2) of hip belt.
- ▶ Close fastening (1) of chest strap.

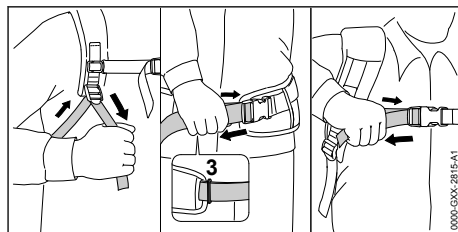

- ▶ Tighten up the straps until the hip belt sits snugly on your hips and the back padding sits snugly on your back.
- ▶ Thread end of hip belt through the loop (3).

### 6.2 Using with Carrying System

#### 6.2.1 Fitting and Adjusting the Connecting Cable

The connecting cable can be fitted and adjusted to suit the user's size and the application.

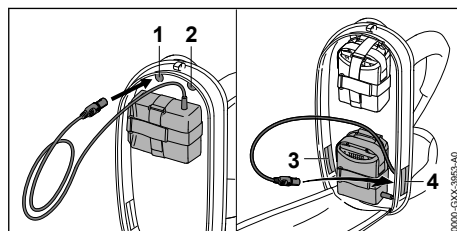

The connecting cable can be fitted through the following openings:

- the upper left opening (1)
- the upper right opening (2)
- the lower left opening (3)
- the lower right opening (4)



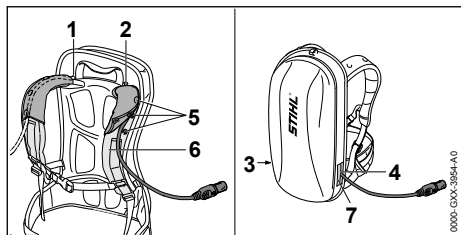

- ▶ If the connecting cable is fitted through the upper left opening (1) or the upper right opening (2):
  - ▶ Open the press studs (5).
  - ▶ Lay the connecting cable over the shoulder strap (6).
  - ▶ Close the press studs (5).
- ▶ If the connecting cable is fitted through the lower left opening (3) or the lower right opening (4): Seal the opening you use (3 or 4) with the hook and loop fastener (7).
- ▶ Arrange the connecting cable so that it is as short as possible without hindering your work.

### 6.2.2 Putting On and Adjusting the Carrying System

- ▶ Place battery on your back.

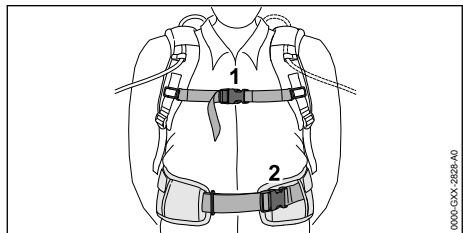

- ▶ Close fastening (2) of hip belt.
- ▶ Close fastening (1) of chest strap.

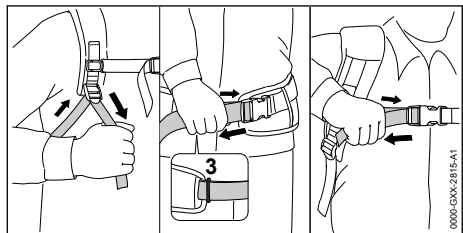

- ▶ Tighten up the straps until the hip belt sits snugly on your hips and the back padding sits snugly on your back.
- ▶ Thread end of hip belt through the loop (3).

## 6.3 Using with AP Belt Bag with Connecting Cable

### 6.3.1 Attaching the "Belt bag AP with connecting cord"

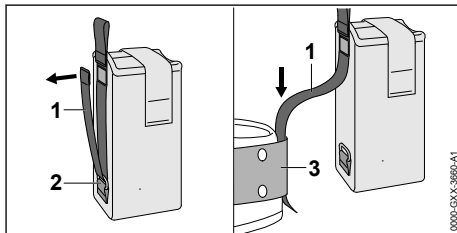

- ▶ Open the Velcro® fastening on the strap (1) and pull the strap (1) out of the ring (2).
- ▶ Feed strap (1) through belt (3).

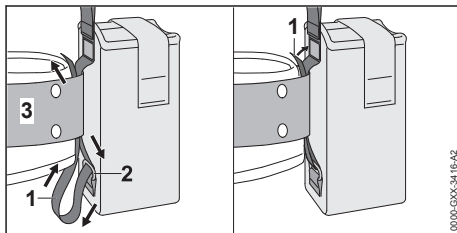

- ▶ Feed strap (1) back through the ring (2) and the belt (3).
- ▶ Close the Velcro® fastening on the strap (1).

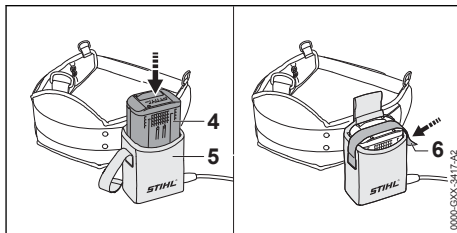

- ▶ Push battery (4) as far as it will go into the belt bag (5).  
A short beep will sound.
- ▶ Secure battery (4) with the Velcro® fastening (6).

### 6.3.2 Adjusting the Connecting Cable

The connecting cable can be fitted and adjusted to suit the user's size and the application.

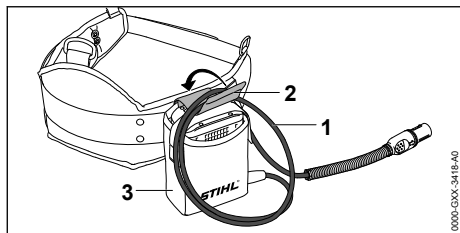

The length of the connecting cable can be adjusted by making a loop (1) and securing it to the belt bag (3) with the fastener (2).

- ▶ Arrange the connecting cable so that it is as short as possible without hindering your work.

## 7 Inserting and Removing Connecting Cable Plug

### 7.1 Inserting the Connecting Cable Plug

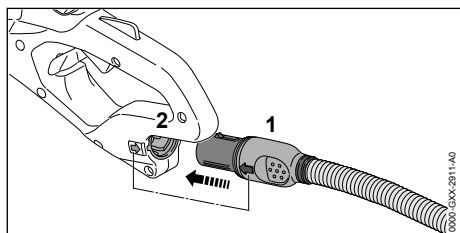

- ▶ Hold connecting cable plug (1) so that the arrow on its side lines up with the arrow on the socket (2).
- ▶ Insert the connecting cable plug (1) in the socket (2).  
The plug (1) engages in position.

### 7.2 Removing the Connecting Cable Plug

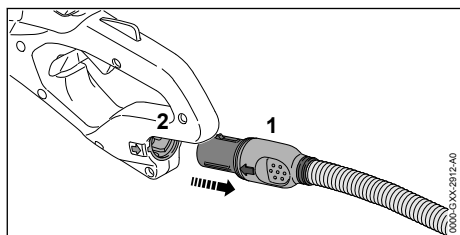

- ▶ Grip the connecting cable plug (1) with your hand.
- ▶ Pull the plug (1) out of the socket (2).

## 8 Switching the Hedge Trimmer On/Off

### 8.1 Switching On



#### WARNING

- The motor accelerates and the cutting blades run regardless of the sequence in which the switch lever and trigger are depressed. If you depress the trigger first and then the switch lever, you may lose control of the hedge trimmer. This can result in serious injuries.
  - ▶ Depress the switch lever first and then the trigger.

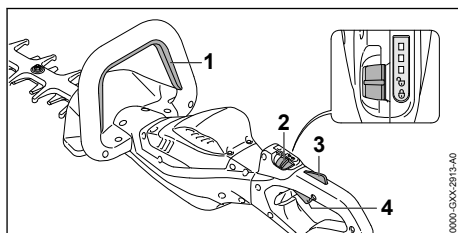

- ▶ Depress the switch lever (1) and hold it in that position.
- ▶ Push the retaining latch (2) with your thumb to position  $\odot$ .
- ▶ Depress the trigger lockout (3) with your hand and hold it there.
- ▶ Pull the trigger (4) with your index finger and hold it there.  
The motor accelerates and the cutting blades run.

The more you depress the trigger, the faster the cutting blades run.

### 8.2 Switching Off

- ▶ Release the switch lever, trigger and lockout lever.
- ▶ Wait until the cutting blades come to a complete standstill after about 1 second.
- ▶ If the cutting blades continue to run after about 1 second: Pull connecting cable plug out of the socket and contact your STIHL servicing dealer.  
Your hedge trimmer has a malfunction.
- ▶ Push the retaining latch into position  $\odot$ .

## 9 Checking the Hedge Trimmer

### 9.1 Checking the Controls

#### Retaining latch, trigger lockout and trigger

- ▶ Pull the connecting cable plug out of the socket.
- ▶ Push the retaining latch into position  $\odot$ .
- ▶ Attempt to pull the trigger lever without depressing the lockout button.
- ▶ If the trigger can be pulled: Do not use your hedge trimmer and contact your STIHL servicing dealer.  
Retaining latch or trigger lockout is faulty.
- ▶ Push the retaining latch into position  $\odot$ .
- ▶ Depress the trigger lockout lever and hold it in that position.
- ▶ Pull the trigger.
- ▶ Release the trigger and trigger lockout lever at the same time.
- ▶ If the trigger or trigger lockout lever is stiff or does not spring back to the idle position: Do not use your hedge trimmer and contact your STIHL servicing dealer.  
Trigger or trigger lockout is faulty.

#### Switch lever

- ▶ Pull the connecting cable plug out of the socket.
- ▶ Depress the switch lever and release it again.
- ▶ If the switch lever is stiff or does not spring back to its idle position: Do not use your hedge trimmer and contact your STIHL servicing dealer.  
The switch lever has a malfunction.

#### Switch on the hedge trimmer

- ▶ Insert the connecting cable plug.
- ▶ Depress the switch lever and release it again.
- ▶ If the cutting blades have run or are running: Do not use your hedge trimmer and contact your STIHL servicing dealer.  
The trigger has a malfunction.
- ▶ Depress the trigger lockout lever and hold it in that position.
- ▶ Pull the trigger and hold it there.
- ▶ If the cutting blades run: Do not use your hedge trimmer and contact your STIHL servicing dealer.  
The switch lever has a malfunction.
- ▶ Depress the switch lever and hold it in that position.  
The cutting blades run.

- ▶ If 3 LEDs flash red: Pull connecting cable plug out of the socket and contact your STIHL servicing dealer.  
There is a malfunction in the hedge trimmer.
- ▶ Release the switch lever.  
The cutting blades stop running after about 1 second.
- ▶ If the cutting blades continue to run after 1 second: Pull connecting cable plug out of the socket and contact your STIHL servicing dealer.  
Your hedge trimmer has a malfunction.

## 10 Operating the Hedge Trimmer

### 10.1 Holding and Controlling the Hedge Trimmer

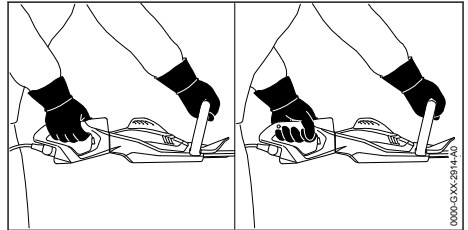

- ▶ Hold the hedge trimmer with one hand on the control handle – wrap your thumb around the control handle.
- ▶ Hold the hedge trimmer with the other hand on the loop handle – wrap your thumb around the loop handle.

### 10.2 Rotating the Control Handle

The control handle can be rotated to any one of three positions to suit the application.

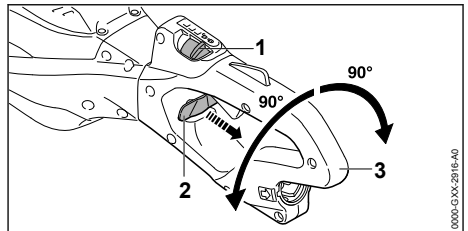

- ▶ Push the retaining latch (1) with your thumb to position  $\odot$ .
- ▶ Pull out and hold the handle lock (2).
- ▶ Rotate the control handle (3) clockwise or counterclockwise.
- ▶ Release the handle lock (2).

- ▶ Continue to rotate the control handle (3) clockwise or counterclockwise until it engages in position.

### 10.3 Setting the performance level

Depending on the application, 3 power levels can be set. The LEDs indicate the selected power level. The higher the power level, the faster the cutting blades can run.

The selected power level affects the battery's runtime. The lower the power level, the longer the runtime.

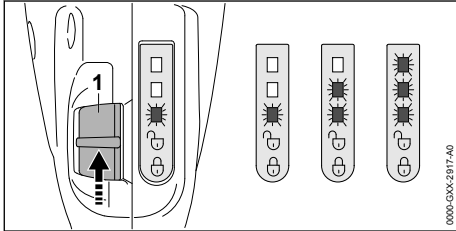

- ▶ Push the retaining latch (1) with your thumb to position . The LEDs indicate the selected power level.
- ▶ Push the retaining latch (1) forwards and allow it to spring back. This selects the next power level. After the third performance level, it starts again with the first performance level.
- ▶ Push the retaining latch (1) forwards and allow it to spring back as many times as necessary to select the required power level.

### 10.4 Cutting

- ▶ Use lopping shears or a chainsaw to cut out thick branches first.

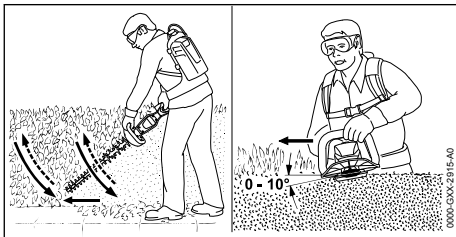

- ▶ Swing the hedge trimmer from the bottom upwards in an arc while making the cut.
- ▶ Lower the nose of the hedge trimmer without cutting.
- ▶ Walk slowly and steadily forwards.
- ▶ Swing the hedge trimmer from the bottom upwards in an arc while making the cut.

- ▶ Cut the other side of the hedge in the same way.
- ▶ Hold the cutting blades at an angle of 0° to 10° to the top of the hedge.
- ▶ Swing the hedge trimmer horizontally and in an arc while making the cut.
- ▶ If cutting performance deteriorates: Sharpen the cutting blades.

## 11 After Finishing Work

### 11.1 After Finishing Work

- ▶ Switch off the hedge trimmer, move retaining latch to position and pull the connecting cable plug out of the socket.
- ▶ If the hedge trimmer is wet: Allow the hedge trimmer to dry.
- ▶ Clean the hedge trimmer.
- ▶ Clean the cutting blades.
- ▶ Fit the blade scabbard so that it completely covers the cutting blades.

## 12 Transporting

### 12.1 Transporting the Hedge Trimmer

- ▶ Switch off the hedge trimmer, move retaining latch to position and pull the connecting cable plug out of the socket.
- ▶ Fit the blade scabbard so that it completely covers the cutting blades.

#### Carrying the hedge trimmer

- ▶ Carry the hedge trimmer by the loop handle with the cutting blades behind you.

#### Transporting the hedge trimmer in a vehicle

- ▶ Secure the hedge trimmer to prevent turnover and movement.

## 13 Storing

### 13.1 Storing the Hedge Trimmer

- ▶ Switch off the hedge trimmer, move retaining latch to position and pull the connecting cable plug out of the socket.
- ▶ Fit the blade scabbard so that it completely covers the cutting blades.
- ▶ Observe the following points when storing the hedge trimmer:
  - Hedge trimmer is out of the reach of children.
  - Hedge trimmer is clean and dry.

## 14 Cleaning

### 14.1 Cleaning the Hedge Trimmer

- ▶ Switch off the hedge trimmer, move retaining latch to position  and pull the connecting cable plug out of the socket.
- ▶ Clean the hedge trimmer with a damp cloth or STIHL resin solvent.
- ▶ Clean vents with a paintbrush.

### 14.2 Cleaning the Cutting Blades

- ▶ Switch off the hedge trimmer, move retaining latch to position  and pull the connecting cable plug out of the socket.
- ▶ Spray both sides of blades with STIHL resin solvent.
- ▶ Insert the connecting cable plug.
- ▶ Run the hedge trimmer for 5 seconds, . The cutting blades run. STIHL resin solvent is distributed evenly.

## 15 Maintenance

### 15.1 Maintenance Intervals

The maintenance intervals are dependent on the environmental and operating conditions. STIHL recommends the following maintenance intervals:

#### After every 50 hours of operation

- ▶ Lubricate the gearbox.

#### Every 12 months

- ▶ Have hedge trimmer checked by a STIHL servicing dealer.

### 15.2 Lubricating the Gearbox

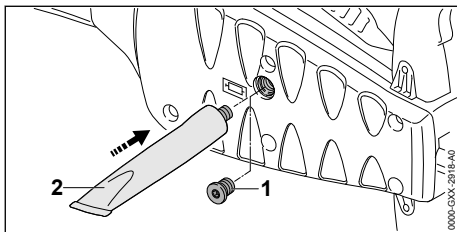

- ▶ Remove the screw plug (1).
- ▶ If no grease can be seen on the end of the screw plug (1):
  - ▶ Screw the tube (2) of STIHL lubricant into the filler hole.
  - ▶ Squeeze 5 g of STIHL gear lubricant into the gearbox.
  - ▶ Unscrew the tube (2) of STIHL gear lubricant.

- ▶ Refit and tighten down the screw plug (1) firmly.
- ▶ Run the hedge trimmer for 1 minute. STIHL gear lubricant is distributed evenly.

### 15.3 Sharpening the cutting blade

STIHL recommends you have the cutting blades resharpened by a STIHL dealer.



#### WARNING

- The teeth of the cutting blades are very sharp. This may result in the user cutting themselves.
  - ▶ Wear work gloves made from resistant material.
- ▶ Switch off the hedge trimmer, move retaining latch to position  and pull the connecting cable plug out of the socket.

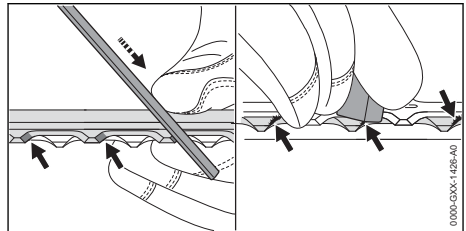

- ▶ Use a STIHL flat file to sharpen each cutting edge on the upper blade. The file only sharpens on the forward stroke. Maintain the prescribed sharpening angle,  18.2.
- ▶ Turn the hedge trimmer over.
- ▶ Sharpen the remaining cutting edges.
- ▶ Deburr each cutting edge from below.
- ▶ Turn the hedge trimmer over.
- ▶ Deburr the remaining cutting edges.
- ▶ Use a damp cloth to remove the filing dust.
- ▶ Spray both sides of cutting blades with STIHL resin solvent.
- ▶ Run the hedge trimmer for 5 seconds. The cutting blades run. STIHL resin solvent is distributed evenly.
- ▶ If you have any doubts, be sure to consult a STIHL dealer.

## 16 Repairing

### 16.1 Repairing Hedge Trimmer and Cutting Blades

The hedge trimmer and cutting blades cannot be repaired by the user.

- ▶ If the hedge trimmer or cutting blades are damaged: Do not use your hedge trimmer and contact your STIHL servicing dealer.

## 17 Troubleshooting

### 17.1 Troubleshooting Hedge Trimmer or Battery

Fault	LEDs on the battery	Cause	Remedy
Hedge trimmer does not start when switched on.	1 LED flashing green.	State of charge of the battery is too low.	► Charge battery as described in the User Manual for STIHL AL 101, 301, 301-4, 500 chargers.
	1 LED emits red light.	The battery is too warm or too cold.	► Pull the connecting cable plug out of the socket. ► Allow the battery to cool down or warm up.
	3 LEDs flash red.	There is a malfunction in the hedge trimmer.	► Pull connecting cable plug out of the socket and plug it in again. ► Switch on the hedge trimmer. ► If 3 LEDs continue to flash red: Do not use your hedge trimmer and contact your STIHL servicing dealer for assistance.
		The cutting blades do not run freely.	► Spray both sides of cutting blades with STIHL resin solvent. ► If 3 LEDs continue to flash red: Do not use your hedge trimmer and contact your STIHL servicing dealer for assistance.
	3 LEDs light up red.	Hedge trimmer is too hot.	► Pull the connecting cable plug out of the socket. ► Allow the hedge trimmer to cool down.
	4 LEDs flashing red.	There is a fault in the battery.	► Pull connecting cable plug out of the socket and plug it in again. ► Switch on the hedge trimmer. ► If 4 LEDs continue to flash red: Do not use the battery; contact a STIHL authorized dealer.
		No electrical contact between the hedge trimmer and battery.	► Pull connecting cable plug out of the socket and plug it in again. ► If the hedge trimmer still fails to start when switched on: Clean the contacts of the connecting cable as described in the STIHL AR battery's User Manual or in the User Manual for the "AP belt bag with connecting cable".
		Hedge trimmer or battery is damp.	► Allow hedge trimmer or battery to dry.
Hedge trimmer cuts out during operation.	3 LEDs light up red.	Hedge trimmer is too hot.	► Pull the connecting cable plug out of the socket. ► Allow the hedge trimmer to cool down.
		There is an electrical fault.	► Pull connecting cable plug out of the socket and plug it in again. ► If the hedge trimmer continues to cut out during operation: Clean the contacts of the connecting cable as described in the STIHL AR battery's User Manual or in the User Manual for the "AP belt bag with connecting cable". ► Switch on the hedge trimmer.
Hedge trimmer's running time is too short.		The battery is not fully charged.	► Fully charge battery as described in the User Manual for the STIHL AL 101, 301, 301-4, 500 chargers.

Fault	LEDs on the battery	Cause	Remedy
		The battery service life has been exceeded.	► Replace battery.

## 18 Specifications

### 18.1 STIHL HSA 94 R, HSA 94 T hedge trimmer

- Permitted batteries:
  - STIHL AR
  - STIHL AP together with “AP belt bag with connecting cable”
- Weight without battery:
  - HSA 94 R, blade length 600 mm: 4.1 kg
  - HSA 94 R, blade length 750 mm: 4.4 kg
  - HSA 94 T, blade length 600 mm: 3.9 kg
  - HSA 94 T, blade length 750 mm: 4.1 kg
- Degree of electrical protection: IPX4 (protection against splash water from any direction)

For runtime, see [www.stihl.com/battery-life](http://www.stihl.com/battery-life).

### 18.2 Cutting blades

#### HSA 94 R

- Tooth spacing: 38 mm
- Cutting length: 600 mm or 750 mm
- Sharpening angle: 45°

#### HSA 94 T

- Tooth spacing: 30 mm
- Cutting length: 600 mm or 750 mm
- Sharpening angle: 45°

### 18.3 Sound Values and Vibration Values

The K-value for sound pressure levels is 2 dB(A).  
K-value for sound power levels is 2 dB(A). The  
K-value for vibration level is 2 m/s<sup>2</sup>.

#### HSA 94 R, cutting length 600 mm

- Sound pressure level  $L_{pA}$  measured as specified in EN 62841-4-2: 83 dB(A)
- Sound power level  $L_{wA}$  measured as specified in EN 62841-4-2: 94 dB(A)
- Vibration level  $a_{hv}$  measured as specified in EN 62841-4-2
  - Control handle: 3.5 m/s<sup>2</sup>
  - Loop handle: 2.7 m/s<sup>2</sup>

#### HSA 94 R, cutting length 750 mm

- Sound pressure level  $L_{pA}$  measured as specified in EN 62841-4-2: 84 dB(A)
- Sound power level  $L_{wA}$  measured as specified in EN 62841-4-2: 95 dB(A)

- Vibration level  $a_{hv}$  measured as specified in EN 62841-4-2
  - Control handle: 3.6 m/s<sup>2</sup>
  - Loop handle: 2.8 m/s<sup>2</sup>

#### HSA 94 T, cutting length 600 mm

- Sound pressure level  $L_{pA}$  measured as specified in EN 62841-4-2: 84 dB(A)
- Sound power level  $L_{wA}$  measured in accordance with 62841-4-2: 95 dB(A)
- Vibration level  $a_{hv}$  measured as specified in EN 62841-4-2
  - Control handle: 3.0 m/s<sup>2</sup>
  - Loop handle: 2.8 m/s<sup>2</sup>

#### HSA 94 T, cutting length 750 mm

- Sound pressure level  $L_{pA}$  measured as specified in EN 62841-4-2: 85 dB(A)
- Sound power level  $L_{wA}$  measured as specified in EN 62841-4-2: 96 dB(A)
- Vibration level  $a_{hv}$  measured as specified in EN 62841-4-2
  - Control handle: 2.5 m/s<sup>2</sup>
  - Loop handle: 2.9 m/s<sup>2</sup>

The vibration levels indicated were measured according to a standardized test method and can be used as a basis for comparing electric power tools. The vibration levels actually occurring may vary from the values indicated, depending on the type of application. The vibration levels indicated can be used for an initial estimate of the vibration stress. The actual vibration stress has to be estimated. The times when the electric power tool is switched off and the times when it is switched on but running under no load can be taken into account in the estimate.

For information on compliance with Employers' Vibration Directive 2002/44/EC see [www.stihl.com/vib](http://www.stihl.com/vib).

### 18.4 REACH

REACH is an EC regulation and stands for the Registration, Evaluation, Authorisation and Restriction of Chemical substances.

For information on compliance with the REACH regulation see [www.stihl.com/reach](http://www.stihl.com/reach).



## 19 Spare Parts and Accessories

### 19.1 Spare parts and accessories

**STIHL** These symbols indicate original STIHL spare parts and original STIHL accessories.

STIHL recommends the use of original STIHL spare parts and accessories.

Despite ongoing market observation, STIHL is unable to judge the reliability, safety and suitability of other manufacturers' spare parts and accessories; accordingly, STIHL cannot warrant for the use of those parts.

Original STIHL spare parts and original STIHL accessories are available from STIHL dealers.

## 20 Disposal

### 20.1 Disposing of Hedge Trimmers

Contact the local authorities or your STIHL dealer for information on disposal.

Improper disposal can be harmful to health and pollute the environment.

- ▶ Take STIHL products including packaging to a suitable collection point for recycling in accordance with local regulations.
- ▶ Do not dispose with domestic waste.

## 21 EC Declaration of Conformity

### 21.1 STIHL HSA 94 R, HSA 94 T hedge trimmer

ANDREAS STIHL AG & Co. KG  
Badstraße 115  
D-71336 Waiblingen  
Germany

declares under our sole responsibility that

- Category: Cordless hedge trimmer
- Manufacturer's brand: STIHL
- Models: HSA 94 R, HSA 94 T
- Serial number: 4869

conforms to the relevant provisions of Directives 2011/65/EU, 2006/42/EC, 2014/30/EU and 2000/14/EC and has been developed and manufactured in compliance with the following standards in the versions valid on the date of production: EN 55014-1, EN 55014-2, EN 62841-1 and EN 62841-4-2.

Applied conformity assessment procedure in accordance with Directive 2000/14/EC, Annex V.

#### HSA 94 R, cutting length 600 mm

- Measured sound power level: 94 dB(A)
- Guaranteed sound power level: 96 dB(A)

#### HSA 94 R, cutting length 750 mm

- Measured sound power level: 95 dB(A)
- Guaranteed sound power level: 97 dB(A)

#### HSA 94 T, cutting length 600 mm

- Measured sound power level: 95 dB(A)
- Guaranteed sound power level: 97 dB(A)

#### HSA 94 T, cutting length 750 mm

- Measured sound power level: 96 dB(A)
- Guaranteed sound power level: 98 dB(A)

The technical documents are stored at  
ANDREAS STIHL AG & Co. KG Produktzulassung.

The year of manufacture, country of manufacture and serial number are applied to the pruning shears.

Waiblingen, 15.07.2021

ANDREAS STIHL AG & Co. KG

*J. Hoffmann*  
pp

Dr. Jürgen Hoffmann, Director Product Certification & Regulatory Affairs

## 22 UKCA Declaration of Conformity

### 22.1 STIHL HSA 94 R, HSA 94 T hedge trimmer

**UK  
CA**

ANDREAS STIHL AG & Co. KG  
Badstraße 115  
D-71336 Waiblingen  
Germany

declares under our sole responsibility that

- Category: Cordless hedge trimmer
- Manufacturer's brand: STIHL
- Models: HSA 94 R, HSA 94 T
- Serial number: 4869

conforms to the relevant provisions of UK regulations The Restriction of the Use of Certain Hazardous Substances in Electrical and Electronic

Equipment Regulations 2012, Supply of Machinery (Safety) Regulations 2008, Electromagnetic Compatibility Regulations 2016 and Noise Emission in the Environment by Equipment for use Outdoors Regulations 2001 and has been manufactured in compliance with the following standards in the versions valid on the date of production: EN 55014-1, EN 55014-2, EN 62841-1, and EN 62841-4-2.

Applied conformity assessment procedure in accordance with UK regulations Noise Emission in the Environment by Equipment for use Outdoors Regulations 2001, Schedule 8.

#### **HSA 94 R, cutting length 600 mm**

- Measured sound power level: 94 dB(A)
- Guaranteed sound power level: 96 dB(A)

#### **HSA 94 R, cutting length 750 mm**

- Measured sound power level: 95 dB(A)
- Guaranteed sound power level: 97 dB(A)

#### **HSA 94 T, cutting length 600 mm**

- Measured sound power level: 95 dB(A)
- Guaranteed sound power level: 97 dB(A)

#### **HSA 94 T, cutting length 750 mm**

- Measured sound power level: 96 dB(A)
- Guaranteed sound power level: 98 dB(A)

The technical documents are stored at  
ANDREAS STIHL AG & Co. KG.

The year of manufacture, country of manufacture and serial number are applied to the pruning shears.

Waiblingen, 15.07.2021

ANDREAS STIHL AG & Co. KG

*J. Hoffmann*  
pp

Dr. Jürgen Hoffmann, Director Product Certification & Regulatory Affairs

## **23 General Power Tool Safety Warnings**

### **23.1 Introduction**

This chapter reproduces the pre-formulated, general safety precautions specified in the IEC 62841 standard for hand-held motor-operated electric tools.

STIHL is obliged to publish these texts.

The safety precautions and warnings on avoiding an electric shock given under "Electrical Safety" do not apply to STIHL cordless products.



#### **WARNING**

- **Read all safety warnings, instructions, illustrations and specifications provided with this power tool.** Failure to follow all instructions listed below may result in electric shock, fire and/or serious injury. **Save all warnings and instructions for future reference.**

The term "electric power tool" in the safety warnings refers to mains-operated (corded) power tools or battery-operated (cordless) power tools.

### **23.2 Work area safety**

- a) **Keep work area clean and well lit.** Cluttered or dark areas invite accidents.
- b) **Do not operate power tools in explosive atmospheres, such as in the presence of flammable liquids, gases or dust.** Power tools create sparks which may ignite the dust or fumes.
- c) **Keep children and bystanders away while operating a power tool.** Distractions can cause you to lose control.

### **23.3 Electrical safety**

- a) **Power tool plugs must match the outlet. Never modify the plug in any way. Do not use any adapter plugs with earthed (grounded) power tools.** Unmodified plugs and matching outlets will reduce risk of electric shock.
- b) **Avoid body contact with earthed or grounded surfaces, such as pipes, radiators, ranges and refrigerators.** There is an increased risk of electric shock if your body is earthed or grounded.
- c) **Do not expose power tools to rain or wet conditions.** Water entering a power tool will increase the risk of electric shock.
- d) **Do not abuse the cord. Never use the cord for carrying, pulling or unplugging the power tool. Keep cord away from heat, oil, sharp edges or moving parts.** Damaged or entangled cords increase the risk of electric shock.
- e) **When operating a power tool outdoors, use an extension cord suitable for outdoor use.** Use of a cord suitable for outdoor use reduces the risk of electric shock.

- f) **If operating a power tool in a damp location is unavoidable, use a residual current device (RCD) protected supply.** Use of an RCD reduces the risk of electric shock.

### 23.4 Personal safety

- a) **Stay alert, watch what you are doing and use common sense when operating a power tool. Do not use a power tool while you are tired or under the influence of drugs, alcohol or medication.** A moment of inattention while operating power tools may result in serious personal injury.
- b) **Use personal protective equipment. Always wear eye protection.** Protective equipment such as a dust mask, non-skid safety shoes, hard hat or hearing protection used for appropriate conditions will reduce personal injuries.
- c) **Prevent unintentional starting. Ensure the switch is in the off-position before connecting to power source and/or battery pack, picking up or carrying the tool.** Carrying power tools with your finger on the switch or energising power tools that have the switch on invites accidents.
- d) **Remove any adjusting key or wrench before turning the power tool on.** A wrench or a key left attached to a rotating part of the power tool may result in personal injury.
- e) **Do not overreach. Keep proper footing and balance at all times.** This enables better control of the power tool in unexpected situations.
- f) **Dress properly. Do not wear loose clothing or jewellery. Keep your hair and clothing away from moving parts.** Loose clothes, jewellery or long hair can be caught in moving parts.
- g) **If devices are provided for the connection of dust extraction and collection facilities, ensure these are connected and properly used.** Use of dust collection can reduce dust-related hazards.
- h) **Do not let familiarity gained from frequent use of tools allow you to become complacent and ignore tool safety principles.** A careless action can cause severe injury within a fraction of a second.

### 23.5 Power tool use and care

- a) **Do not force the power tool. Use the correct power tool for your application.** The correct

power tool will do the job better and safer at the rate for which it was designed.

- b) **Do not use the power tool if the switch does not turn it on and off.** Any power tool that cannot be controlled with the switch is dangerous and must be repaired.
- c) **Disconnect the plug from the power source and/or remove the battery pack, if detachable, from the power tool before making any adjustments, changing accessories, or storing power tools.** Such preventive safety measures reduce the risk of starting the power tool accidentally.
- d) **Store idle power tools out of the reach of children and do not allow persons unfamiliar with the power tool or these instructions to operate the power tool.** Power tools are dangerous in the hands of untrained users.
- e) **Maintain power tools and accessories.** Check for misalignment or binding of moving parts, breakage of parts and any other condition that may affect the power tool's operation. **If damaged, have the power tool repaired before use.** Many accidents are caused by poorly maintained power tools.
- f) **Keep cutting tools sharp and clean.** Properly maintained cutting tools with sharp cutting edges are less likely to bind and are easier to control.
- g) **Use the power tool, accessories and tool bits etc. in accordance with these instructions, taking into account the working conditions and the work to be performed.** Use of the power tool for operations different from those intended could result in a hazardous situation.
- h) **Keep handles and grasping surfaces dry, clean and free from oil and grease.** Slippery handles and grasping surfaces do not allow for safe handling and control of the tool in unexpected situations.

### 23.6 Battery tool use and care

- a) **Recharge only with the charger specified by the manufacturer.** A charger that is suitable for one type of battery pack may create a risk of fire when used with another battery pack.
- b) **Use power tools only with specifically designated battery packs.** Use of any other battery packs may create a risk of injury and fire.
- c) **When battery pack is not in use, keep it away from other metal objects, like paper clips, coins, keys, nails, screws or other**

- small metal objects, that can make a connection from one terminal to another.** Shorting the battery terminals together may cause burns or a fire.
- d) **Under abusive conditions, liquid may be ejected from the battery; avoid contact. If contact accidentally occurs, flush with water. If liquid contacts eyes, additionally seek medical help.** Liquid ejected from the battery may cause irritation or burns.
  - e) **Do not use a battery pack or tool that is damaged or modified.** Damaged or modified batteries may exhibit unpredictable behaviour resulting in fire, explosion or risk of injury.
  - f) **Do not expose a battery pack or tool to fire or excessive temperature.** Exposure to fire or temperature above 130 °C may cause explosion.
  - g) **Follow all charging instructions and do not charge the battery pack or tool outside the temperature range specified in the instructions.** Charging improperly or at temperatures outside the specified range may damage the battery and increase the risk of fire.

23.7 Service

- a) **Have your power tool serviced by a qualified repair person using only identical replacement parts.** This will ensure that the safety of the power tool is maintained.
- b) **Never service damaged battery packs.** Service of battery packs should only be performed by the manufacturer or authorized service providers.

23.8 Hedge trimmer safety warnings

Safety instructions for hedge trimmers

- a) **Keep all parts of the body away from the blade. Do not remove cut material or hold material to be cut when blades are moving.** Blades continue to move after the switch is turned off. A moment of inattention while operating the hedge trimmer may result in serious personal injury.
- b) **Carry the hedge trimmer by the handle with the blade stopped and taking care not to operate any power switch.** Proper carrying of the hedge trimmer will decrease the risk of inadvertent starting and resultant personal injury from the blades.
- c) **When transporting or storing the hedge trimmer, always fit the blade cover.** Proper han-

- dling of the hedge trimmer will decrease the risk of personal injury from the blades.
- d) **When clearing jammed material or servicing the unit, make sure all power switches are off and the power cord is disconnected.** Unexpected actuation of the hedge trimmer while clearing jammed material or servicing may result in serious personal injury.
  - e) **Hold the hedge trimmer by insulated gripping surfaces only, because the blade may contact hidden wiring or its own cord.** Blades contacting a "live" wire may make exposed metal parts of the hedge trimmer "live" and could give the operator an electric shock.
  - f) **Keep all power cords and cables away from cutting area.** Power cords or cables may be hidden in hedges or bushes and can be accidentally cut by the blade.
  - g) **Do not use the hedge trimmer in bad weather conditions, especially when there is a risk of lightning.** This decreases the risk of being struck by lightning.

Table des matières

1	Préface.....	39
2	Informations concernant la présente Notice d'emploi.....	39
3	Vue d'ensemble.....	40
4	Prescriptions de sécurité.....	41
5	Préparatifs avant l'utilisation du taille-haies.....	45
6	Ajustage du taille-haies selon l'utilisateur.....	46
7	Branchement et débranchement de la fiche du cordon d'alimentation électrique.....	48
8	Mise en marche et arrêt du taille-haies.....	49
9	Contrôle du taille-haies.....	49
10	Travail avec le taille-haies.....	50
11	Après le travail.....	51
12	Transport.....	51
13	Rangement.....	51
14	Nettoyage.....	51
15	Maintenance.....	52
16	Réparation.....	52
17	Dépannage.....	53
18	Caractéristiques techniques.....	54
19	Pièces de rechange et accessoires.....	55
20	Mise au rebut.....	55
21	Déclaration de conformité UE.....	55
22	Déclaration de conformité UKCA.....	56

Traduction de la Notice d'emploi d'origine  
0000009299\_006\_F  
Imprimé sur papier blanc sans chlore  
L'encore d'impression contient des huiles végétales, le papier est recyclable  
© ANDREAS STIHL AG & Co. KG 2022  
0458-005-9621-B; V.1.1.E22.

[www.stihl.com](http://www.stihl.com)



0458-005-9621-B

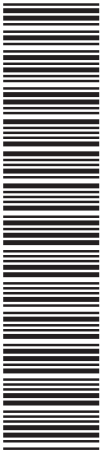

0458-005-9621-B