



Rammer Breakers
Models 111, 222 and 333

**Ram
mer®**

Application specific product solution

Rammer's all-new 111, 222 and 333 models combine simplicity and cost-effectiveness with a class-leading, power-to-weight ratio that is ideally suited to demolition and recycling applications.

The three models benefit from a sturdy, but lightweight, slim design that allows them to operate effectively in narrow and confined work areas. A new innovation of the hammers is Rammer's all-new, built-in Pressure Release System (PRS) which enables fast, safe hose removal for quick-couplers.

These class-leading models can be installed on a wide-range of mini-excavators, skid-steer loaders and other compact carriers ranging from 1,800 lbs. to 8,800 lbs. The all-new Model 111, Model 222 and Model 333 hammers are capable of accepting a wide-range of oil input and return flows and pressures.

The simple design of these breakers results in 30% fewer parts, no tie rods, a maintenance-free accumulator and a one-piece tool bushing. Featuring just two moving parts, these all-new hammers minimize maintenance and reduce owning and operating costs.

The replacement of the single lower tool bushing can be accomplished in a matter of minutes for minimal downtime and greater profitability. And, none of the three breakers require routine accumulator recharging as is required on some hammer models.

SPECIAL FEATURES OF THE MODEL 111, 222 AND 333:

- Slim design for easy access to narrow, confined areas
- Pressure Release System (PRS) for fast and safe hose removal for quick-couplers
- Maintenance-free accumulator
- Light weight for broad carrier adaptability
- Single lower tool bushing reduces maintenance time and cost
- 30% fewer parts reduces cost
- High blow frequency increases production
- No tie rods for less maintenance

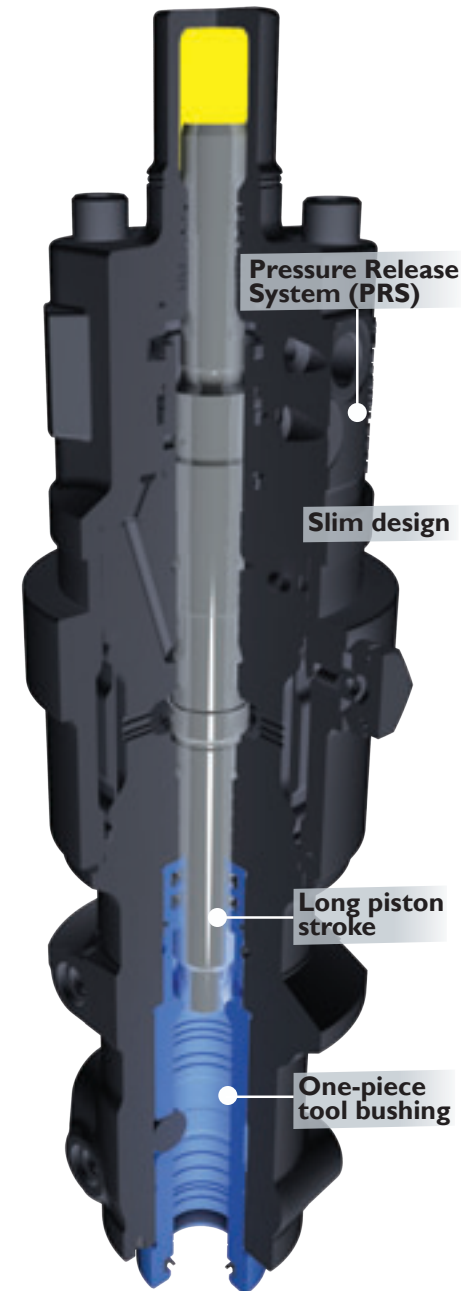

Model		111	222	333
Mounting Type		IN 1	IN 1	IN 2
Foot Pound Energy Class	ft. lbs.	150	200	350
Frequency Range	bpm	1,000-2,600	1,100-2,600	1,050-2,050
Hydraulic Flow Required Range	gpm (lpm)	4-9 (15-33)	5-13 (20-48)	8-17 (30-63)
Hydraulic Pressure Range	psi (bar)	1,150-1,900 (80-130)	1,450-2,200 (100-150)	1,450-2,200 (100-150)
Working Weight	lbs. (kg)	150 (70)	230 (105)	330 (150)
Overall Length	in. (cm)	31 (79)	35 (89)	40 (102)
Standard Demolition Tool		Conical	Conical	Conical
Tool Diameter	in. (mm)	1.42 (36)	1.65 (42)	1.97 (50)
Recommended Carrier Weight	lbs.	1,800-4,000	2,600-5,300	4,400-8,800

Mounting Descriptions: IN 1-Flat-Top • IN 2-Flat-Top



3900 Kelley Avenue, Cleveland, Ohio 44114
Tel: 216-431-2600 Fax: 216-431-2601
e-mail: Sales@AlliedCP.com
website: <http://www.AlliedCP.com>



For sales and service, contact your Allied Distributor: